



Artistic Image

### LOCATION ADVANTAGES

- Near Pataudi Road.
- Near National Highway 8 (width: 150m/60m)
- Near Sector 21, Dwarka Metro Station, connecting to the blue line.
- Near Mehrauli-Gurugram road
- In close proximity to movie theatres, schools and hospitals.
- Near Delhi through NPR
- Near Delhi International Airport through NPR
- Near NH8, Hero Honda Chowk
- 1 Km from existing Sector 9 and 10 of Gurugram.

Size	Unit Type	No. of Units	Carpet Area (sq.ft.)	Balcony Area (sq. ft.)*	Total Cost	Application Money (5%)	Allotment (20%)
2 BHK	T1	346	552.360	79.653	Rs. 2249267.600	Rs. 112463.380	Rs. 449853.519
2 BHK	T2	346	585.944	79.545	Rs. 2383547.252	Rs. 119177.362	Rs. 476709.450
2 BHK	T3	346	519.229	79.653	Rs. 2116742.463	Rs. 105837.123	Rs. 423348.492
2 BHK	T4	336	596.126	79.653	Rs. 2424331.669	Rs. 121216.583	Rs. 484866.333
1 BHK	T5	2	496.905	59.094	Rs. 2617866.591	Rs. 130893.329	Rs. 523573.318

**CLOSE TO EVERYTHING.  
FAR FROM THE ORDINARY.**



DESIGNED BY  
PADMAHUSHAN  
HAFEZ  
CONTRACTOR



**2 BHK  
₹21.16 LACS\*  
ONWARDS**

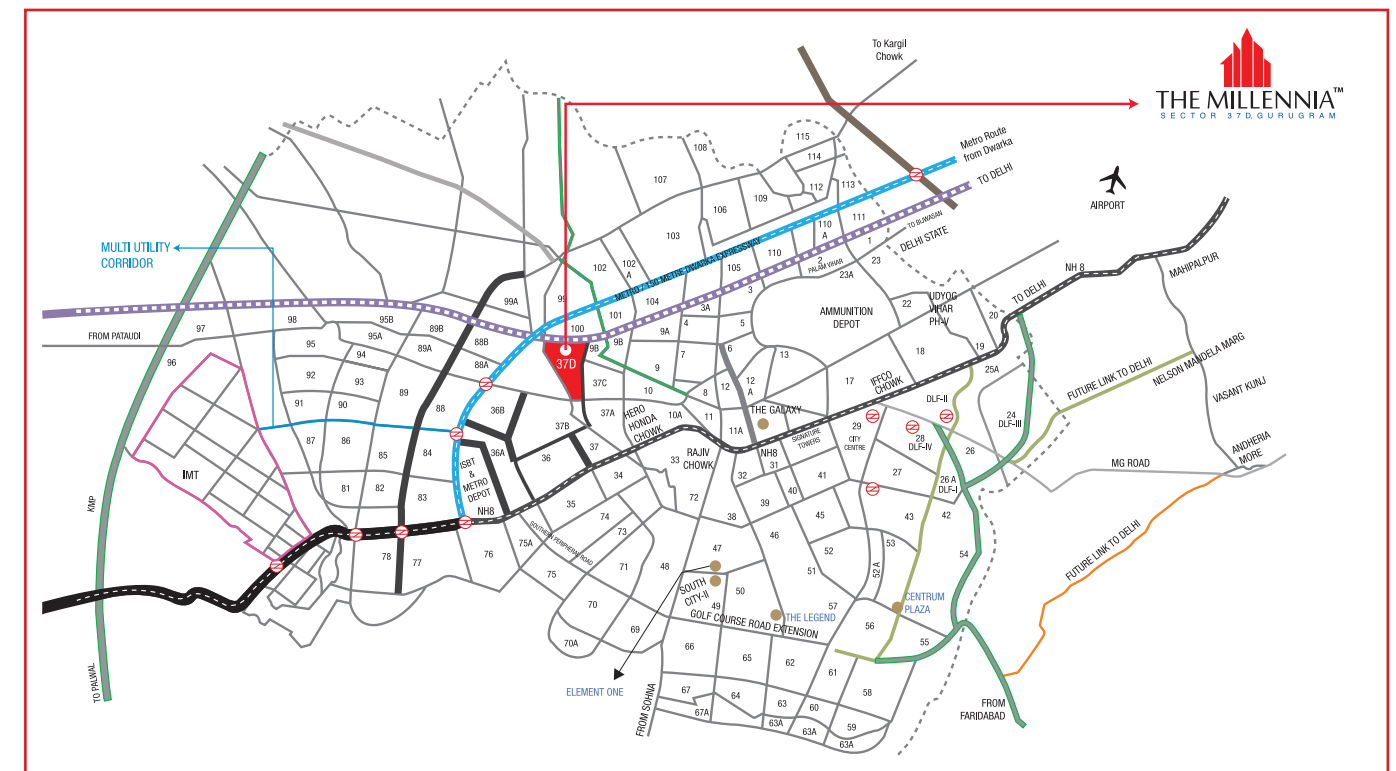

**SIGNATUREGLOBAL (INDIA) PVT. LTD. CIN: U70101DL2011PTC220275**  
Corporate office, 13<sup>th</sup> floor, Tower A, Signature Towers, Gurugram - 122001

EMD FINANCE AVAILABLE

**SIGNATURE GLOBAL CAPITAL** | **smc finance** | **pnb Housing** | **Indiabulls HOME LOANS** | **RAAS** | **HDFC HOME LOANS** | **ICICI Bank** | **TATA CAPITAL Home Loans**

**DISCLAIMER:**  
"THIS PICTURE IS THE ARCHITECTURAL MODEL/REPRESENTATION OF THE THE MILLENNIA, PROPOSED TO DEVELOPED BY SIGNATUREGLOBAL (INDIA) PVT. LTD."  
THE CONTENTS, PICTURES, IMAGES ETC. PROVIDED IN THE ADVERTISEMENT/ MARKETING/ PROMOTIONAL ACTIVITY ARE PURELY INDICATIVE IN NATURE AND NOT ACTUAL DEPICTION OF THE BUILDINGS/ LANDSCAPES ETC. THE REAL ESTATE (REGULATION AND DEVELOPMENT) ACT, 2016 AND THE RULES MADE THEREUNDER ("RERA") HAS BROUGHT ABOUT SIGNIFICANT CHANGES TO THE REAL ESTATE SECTOR. SIGNATUREGLOBAL IS FULLY COMMITTED TO BE COMPLIANT WITH THE PROVISIONS UNDER RERA. SIGNATUREGLOBAL URGES THE APPLICANT TO INSPECT THE SITE WHERE THE PROJECT IS PROPOSED TO BE CONSTRUCTED. THE APPLICANT SHALL NOT MERELY RELY OR BE INFLUENCED BY ANY ARCHITECT'S PLAN, SALES PLAN, SALES BROCHURES, ADVERTISEMENT, REPRESENTATIONS, WARRANTIES, STATEMENTS OR ESTIMATES OF ANY NATURE WHATSOEVER, WHETHER WRITTEN OR ORAL, MADE BY SIGNATUREGLOBAL AND SHALL MAKE HIS PERSONAL JUDGMENT PRIOR TO BOOKING AN APARTMENT IN ANY PROJECT OF SIGNATUREGLOBAL, YOU ARE REQUESTED TO CONTACT OUR SALES TEAM TO UNDERSTAND AND BE WELL-VERSED WITH THE CURRENT DETAILS REGARDING ANY PROJECT AND ONLY THEREAFTER YOU ARE REQUESTED TO EVALUATE THE DECISION TO BOOK AN APARTMENT IN ANY PROJECT OF SIGNATUREGLOBAL.  
\*RS 500 PER SQFT AGAINST ALL BALCONY AREA IN A FLAT ADDING UPTO AND LIMITED TO 100 SQFT, AS PERMITTED IN THE APPROVED BUILDING PLANS.  
RATE MENTIONED IS EXCLUSIVE OF ALL TAXES AS APPLICABLE.

T & C apply. 1 sq.mt. = 10.7639 sq.ft.



1. DROP OFF FOR TOWER
2. JOGGING TRACK / BICYCLE PATH
3. TODDLERS PLAY AREA
4. SOCIAL GATHERING SPACE & EVENT LAWN
5. LEISURE COURT
6. YOGA AND MEDITATION LAWN
7. OUTDOOR GYM
8. COMMERCIAL PLAZA
9. THEMATIC GARDEN
10. PALM COURT
11. MULTI PURPOSE COURT
12. AMPHITHEATRE
13. FRAGRANT COURT
14. CHILDREN'S PLAY AREA
15. SENIOR CITIZENS SIT OUT
16. WALL CLIMBING FOR CHILDREN
17. SKATING RINK
18. KIDS MINI SOCCER AREA
19. WATER BODY

**2 BHK - T1**

**2 BHK - T2**



CARPET AREA: 552.360 SQFT  
BALCONY AREA: 79.653 SQFT



CARPET AREA: 585.944 SQFT  
BALCONY AREA: 79.545 SQFT



Architectural Image



Architectural Image

**2 BHK - T3**

**2 BHK - T4**



CARPET AREA: 519.229 SQFT  
BALCONY AREA: 79.653 SQFT

CARPET AREA: 596.126 SQFT  
BALCONY AREA: 79.653 SQFT



Architectural Image

Architectural Image

## 1 BHK - T5



CARPET AREA: 496.905 SQFT  
BALCONY AREA: 59.094 SQFT



Architectural Image



अफॉर्डबल होम्स -  
हमारा एक कदम देश को  
बेहतर बनाने की ओर।

## SITE PLAN

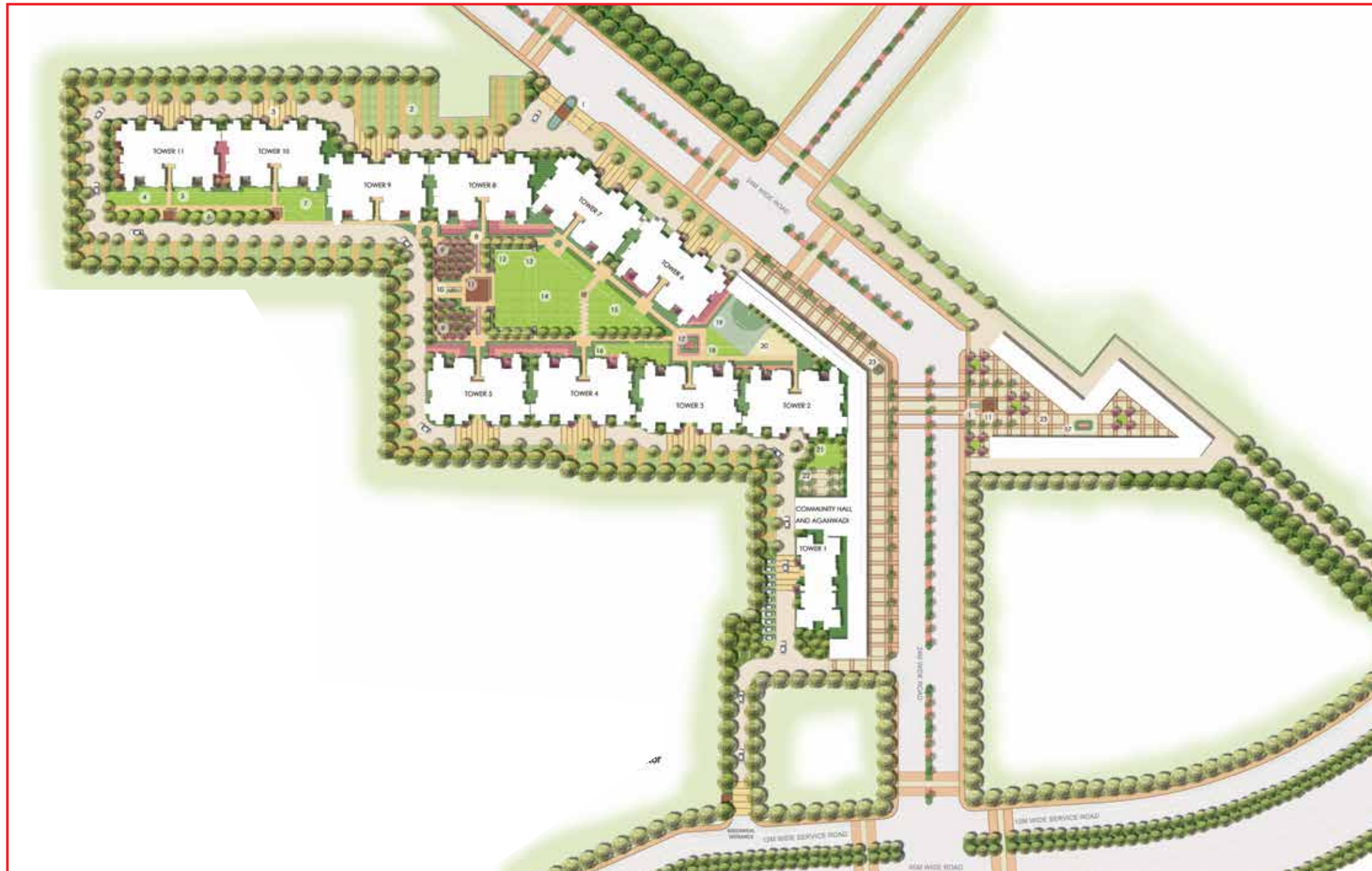

Artistic Site Plan

**Disclaimer:**

All the fixtures and interiors shown inside in apartment are not the part of standard apartment.